

Step 1

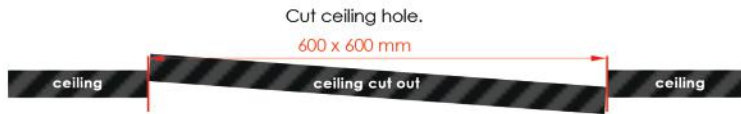

Step 2

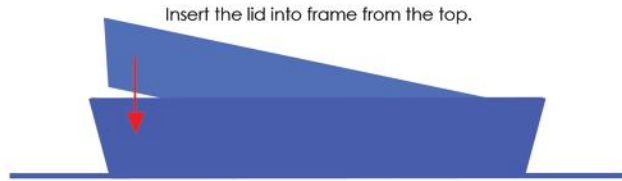

Step 3

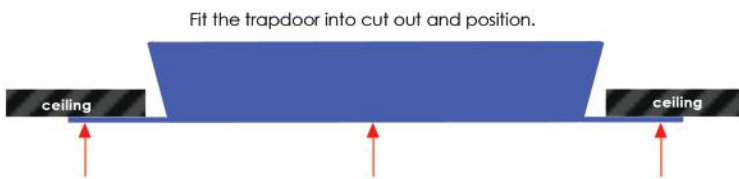

Step 4

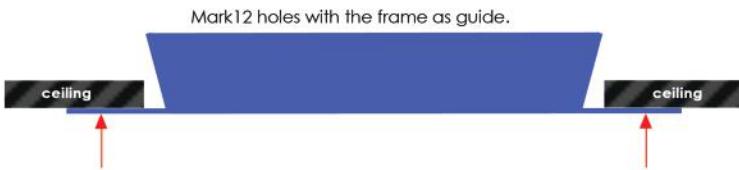

Step 5

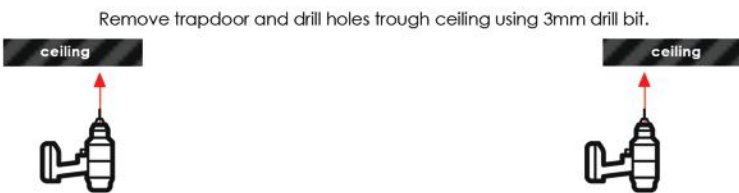

Step 6

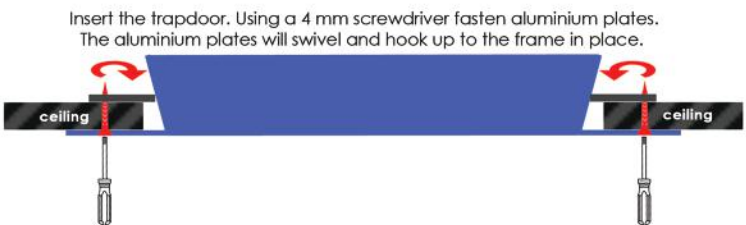

For total reliability you can count on.

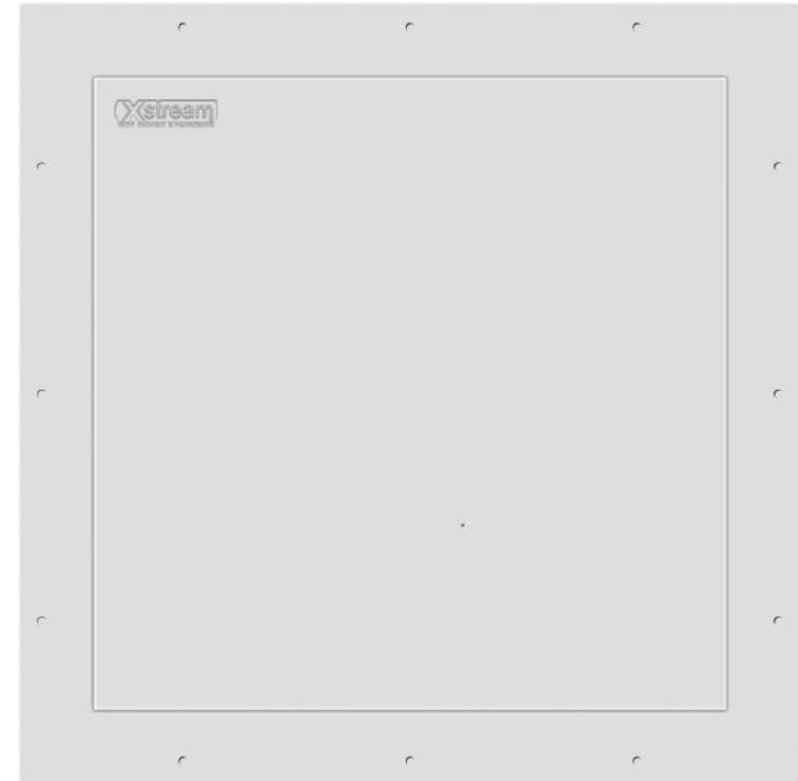

Tel: +27 21 872 0900
Distillery Road, Paarl 7646

E-mail: info@xstream.co.za

website: www.xstream.co.za
PO BOX 3132, Paarl 7620



Introducing the Xstream fibreglass trap door.

Designed with durability, simplicity and aesthetics in mind, this trapdoor can be fitted in existing ceilings without too much of a hassle, accepting bigger size geysers and can be cleaned without even breaking a sweat.



Features:

- Easy fitment.
- Aesthetically pleasing.
- Cleans easily.
- Can be painted.
- Durable.
- Can be fitted to existing trapdoor opening.

This kit consists of:

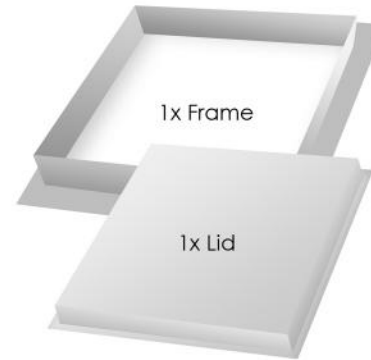

12 x Stainless Steel Screws (4 x 35 mm)



12 x Washers (11 x 1 mm) Holesize 4 mm



You will need:

Battery drill with 4 mm drill bit



4 mm phillips screwdriver



Dimensions:

